

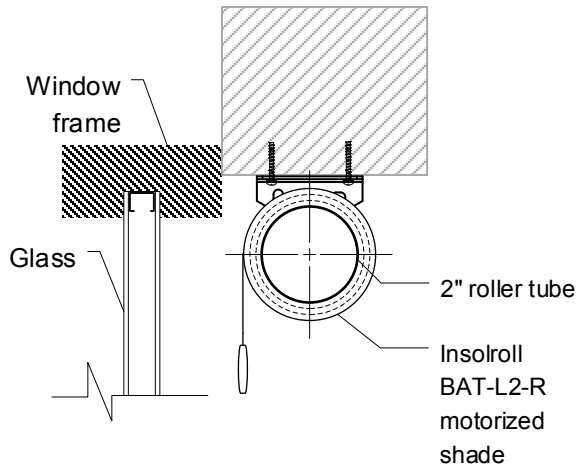

# BAT-L2-R BATTERY MOTORIZED SHADE

## Li-ion Rechargeable Motor Shades with Exposed Roller



**Section View**

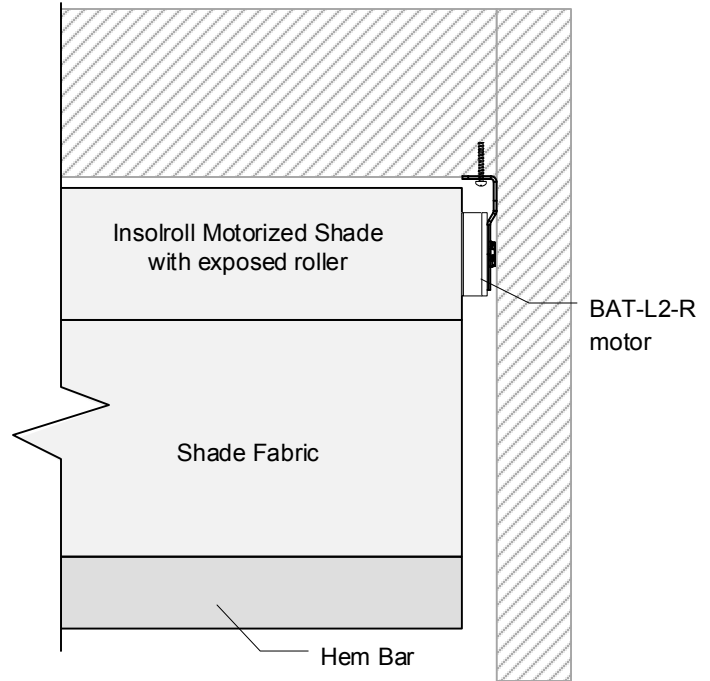

**Front View  
inside mount**

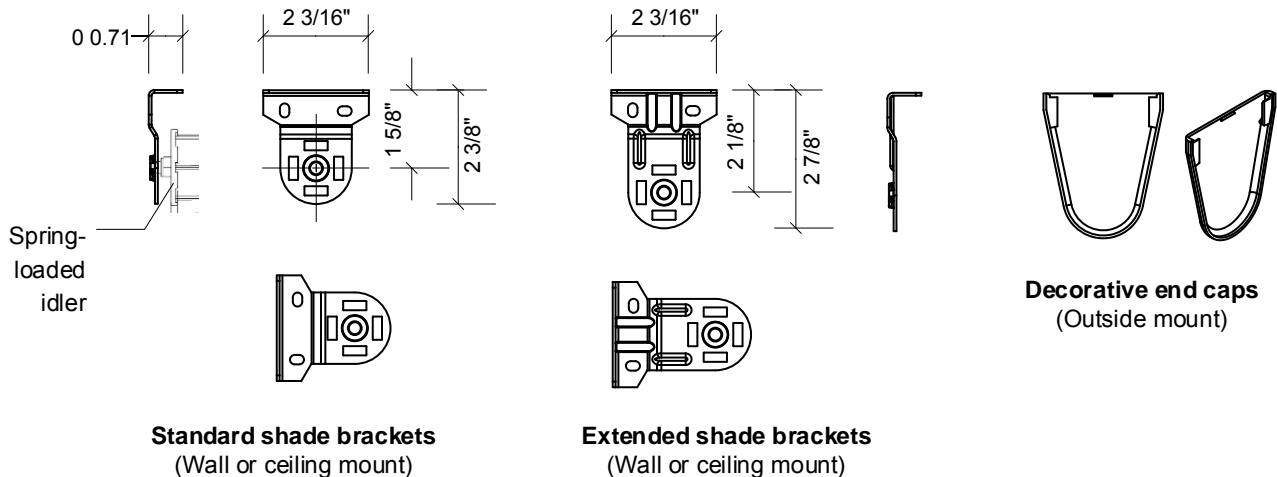

**Notes:**

1. BAT-L2-R Quiet Rechargeable Li-ion Motor has battery imbedded inside the motor.
2. Optional 94" extension charging cable is available for shades with difficult access. **Do NOT leave charger plugged into motor.** Constant charging of motor causes premature wear on the battery pack.
3. Shade Roll Diameter varies depending upon shade height and fabric and roller tube specified.
4. Fabric deductions are 23/32" on motor side and 21/32" idler side (1 3/8" overall fabric deduction from outside bracket width). Optional decorative end caps add 1/8" to each bracket.
5. Shades taller than 84" require extended mounting brackets.