

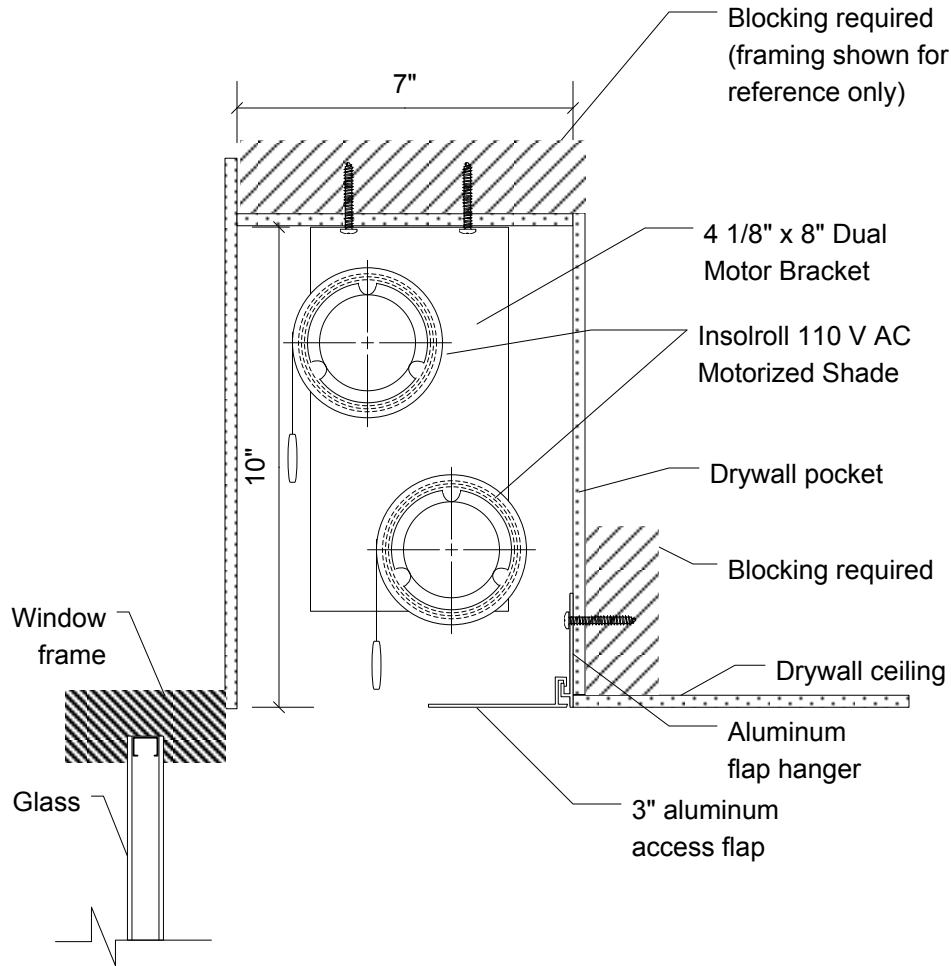

INSOLROLL DUAL MOTORIZED SHADE

110 V AC Motor in Site-built Pocket (UL Listed System)



**Dual 110 V AC Motorized Shades
In Site-built Pocket**

Notes:

1. Shade Roll Diameter varies depending upon shade height and fabric and roller tube specified.
2. Insolroll Shades with 110 V AC Motors (STD-AC, STD-ACR, STD-ILT-AC, IQM-AC, IQM-ACR, IQM-ILT-AC) are complete UL Listed systems with a 10' SJT rated pigtail and include a UL Listed label on roller tube.